

Bermuda 115 x 80mm

Bermuda Floor Grates are easy to install, Australian made using DZR Diecast brass, and Australian Watermark approved.

Features: An 80mm strainer is supplied.

Finish: Chrome, Black Chrome, Satin Chrome, Polished Brass, Gold Plate



Specifications

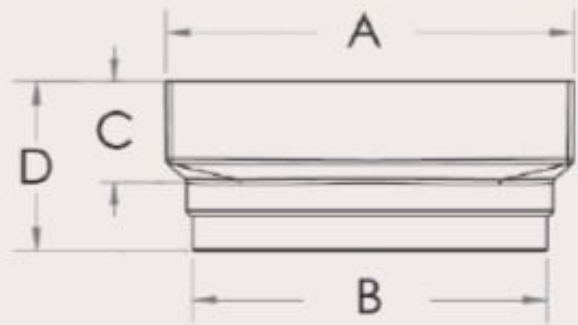
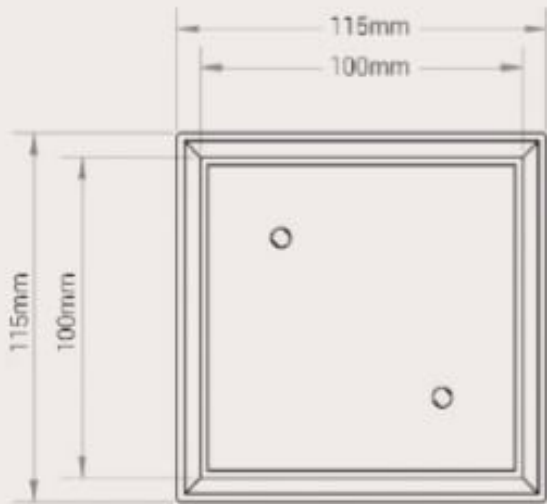
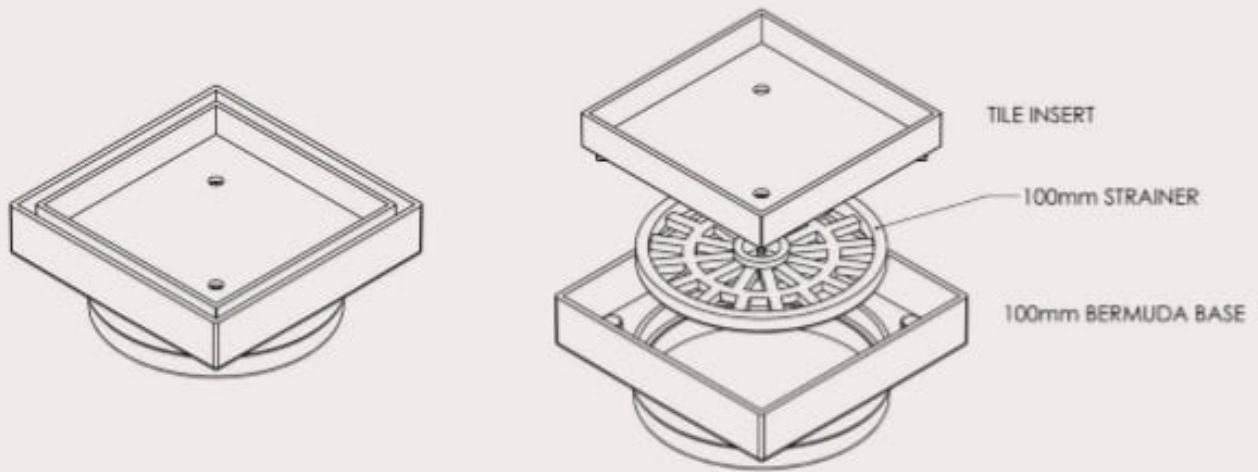

CODES	A	B	C	D
11101.01	115	100.0	28	48
11102.01	115	74.8	28	48