

## Halo X Wall Taps

In the new Halo X range, Brodware's signature knurling is etched around the crisp minimal face of our speciality brass to deliver tactile and visual elegance in any chosen space. Drawing from the timeless simplicity of the circle, the Halo X is controlled by rotation, allowing for a simple, satisfying method to regulate the flow and temperature of water.

This range, an ergonomic addition to our highly sought-after Halo range, includes a variety of fittings tailored to specific applications. With an array of PVD coatings available, the subtle sophistication of Halo X tapware can be finely tuned to meet your stylistic preference and blend seamlessly with the overall character of your bathroom or kitchen.

Features: Easiglide® 1/4 turn ceramic spindles.  
Supplied as a pair (Hot & Cold).

Options: Can be mounted horizontal or vertical  
(specify when ordering).

Finish: Available in all Brodware finishes.

Installation: Wall taps must have tap body face  
20mm behind the finished wall face. See  
instruction

### Specifications



---

#### HALO WALL TAPS WITH KNURLED HANDLES

1.9549.00.7.XX

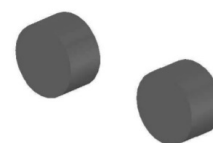

---

#### PRODUCT DIMENSIONS:

Front view:



Side view:



Top view:

